

**CAST IRON MANHOLE EXTENSION RING ER C.I.**

**MHERCI**

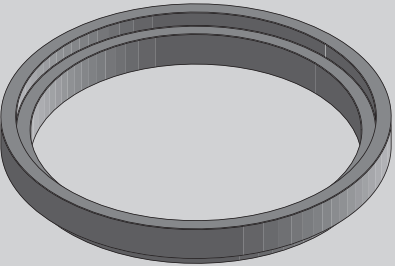

**APPROXIMATE WEIGHT—VARIES**

**CLASS 35**

**NOTES:**  
**SPECIAL SIZES AVAILABLE**  
**ANGULAR RINGS MADE UPON REQUEST**

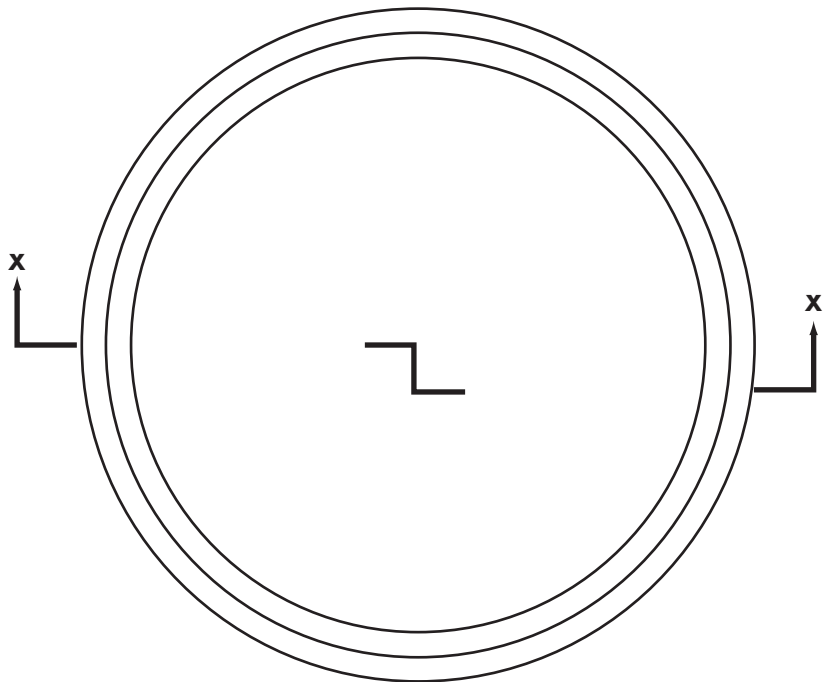

**STANDARD SIZES**

RISE (inches)	LID DIAM. (inches)	APPROX. WT (lbs)
1 1/2	23	40
2	23	60
1 1/4	24	40
1 1/2	24	45
2	24	58
2 1/2	24	70
3	24	72
4	24	81
6	24	106
2	28-28 1/2	72
1 1/2	30	55
2	30	70
2 1/2	30	86
3	30	104

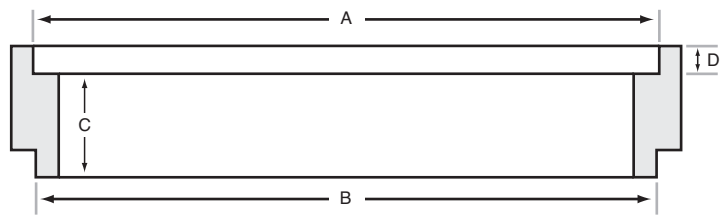

SECTION X-X

WHEN ORDERING SPECIAL SIZES, STATE THE FOLLOWING:

- A - LID OPENING DIAMETER
- B - LID DIAMETER
- C - EXTENSION RISE
- D - LID THICKNESS

